

START YOUR DREAM HOME JOURNEY IN PRIME JHAJJAR

“WHERE LIFE HEALS, PLAYS, AND WORKS”

DAA Home Avenue is a prestigious RERA-approved residential township spread across **5 acres** of thoughtfully planned land in **Sector 29, Jhajjar**. It embodies a vision of harmonious living, promoting a perfect balance of nature, wellness, vibrant community life, and seamless connectivity to nearby urban hubs. The township is designed to ensure that every aspect of your lifestyle — from relaxation and recreation to productivity and socializing — is enriched within a serene and secure environment.

CONTACT US

DISCLAIMER

Promoter urges every applicant to inspect the project site personally and not solely rely upon brochures, architectural impressions, or marketing materials. The project is being developed in phases; therefore, certain facilities and amenities may be shared among residents of different phases. Images, visuals, and content in marketing materials are for illustrative purposes only, and the actual product may vary. Journey time is indicative and may vary based on traffic and conditions.



DAA Home Avenue

Rera No. HRERA-PKL-JJR-723-2025



PROJECT OVERVIEW

Palm Avenue is not just a township; it is an experience of holistic living. Designed with the "Heal, Play, Work" philosophy.

Each element of the township is carefully planned to enhance mental, physical, and emotional wellbeing, offering a safe and inspiring environment for families to thrive.

WHERE LIFE HEALS, PLAYS, AND WORKS

ABOUT US



DAA Home Avenue, a pioneering name in Haryana's real estate sector, was established with a clear vision: to deliver superior residential and commercial projects that resonate with excellence, affordability, and trust.

Founded by industry veterans, DAA Home Avenue has consistently prioritized customer satisfaction, building a reputation anchored in reliability, transparency, and innovation.

DAA Home now introduces **Avenue** — a project that is not just about building homes, but crafting lifestyles.

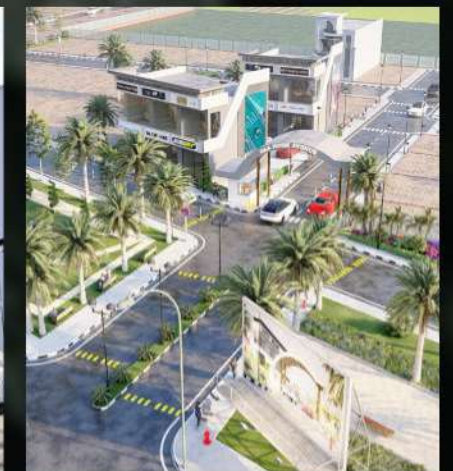

THE TOWNSHIP OFFERS:

01

Gated Community Living:

With controlled entry and round-the-clock security

02

Green Landscapes:

Lush parks, tree-lined avenues, and eco-friendly design

03

Modern Infrastructure:

Wide paved roads, underground wiring, efficient drainage systems.

04

Residential Freehold Plots:

Ready-to-build spaces for your customized dream home.

DAA HOME AVENUE

CORE MANTRAS



Tradition of Trust



Delivering Excellence



Building Relationships



BADMINTON COURT

MODERN AMENITIES



CLUBHOUSE

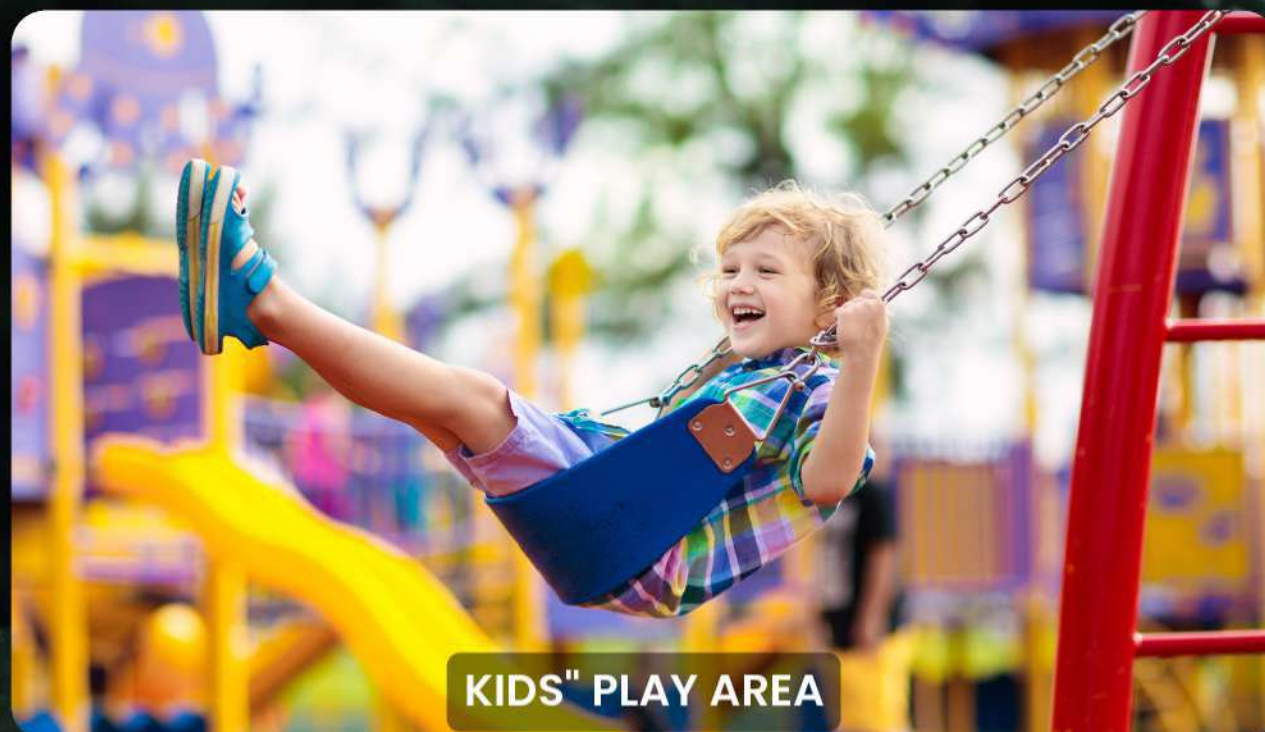

KIDS" PLAY AREA



YOGA ZONE

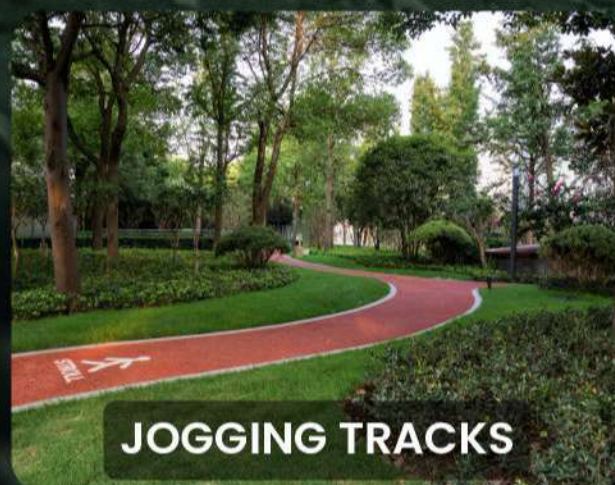

JOGGING TRACKS



24X7 CCTV SECURITY



SOLAR LIGHTING



OPEN-AIR GYM



PLOTS AREA CALCULATION							
S.NO	PLOT NO	WIDTH IN M	LENGTH IN M	AREA/PLOT IN SQM	AREA/PLOT IN SQYDS	NO OF PLOTS	TOTAL AREA IN SQM
1	1	$1/2 \times (12.73 + 14.78) \times 7.00$		96.285	115.157	1	96.285
2	2	$1/2 \times (14.78 + 16.82) \times 7.00$		110.600	132.278	1	110.600
3	3	AS/CALCULATIONS		132.628	158.623	1	132.628
4	4-6	7.500	18.000	135.000	161.460	3	405.000
5	7-12, 12A, 14-19	7.500	17.000	127.500	152.490	13	1657.500
6	20	AS/CALCULATIONS		107.994	129.161	1	107.994
7	21	7.750	17.580	136.245	162.949	1	136.245
8	22-30	7.750	18.500	143.375	171.477	9	1290.375
9	31-40	7.000	16.140	112.980	135.124	10	1129.800
10	41	7.350	16.140	118.629	141.880	1	118.629
11	42-51	7.700	17.000	130.900	156.556	10	1309.000
12	52-63	8.400	17.400	146.160	174.807	12	1753.920
13	64-65	8.000	17.000	136.000	162.656	2	272.000
14	66	7.840	16.740	131.242	156.965	1	131.242
15	67-76	7.800	16.740	130.572	156.164	10	1305.720
16	77-80	8.300	17.280	143.424	171.535	4	573.696
TOTAL						80	

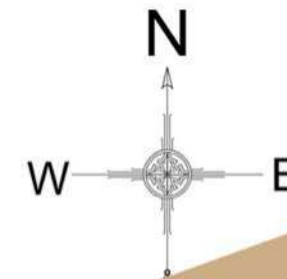

LAYOUT

LOCATION ADVANTAGE



Excellent Connectivity



Proximity to Amenities



Healthcare Facilities



Educational Facilities



Future Growth Hub

OUR VALUES



RERA REGISTERED



FREEHOLD RESIDENTIAL PLOTS



VASTU COMPLIANT LAYOUT



CLEAR TITLE AND LEGAL COMPLIANCE



RAINWATER HARVESTING SYSTEM



WIDE ROADS AND MODERN INFRASTRUCTURE



AFFORDABLE INVESTMENT WITH HIGH APPRECIATION



TREE-LINED AVENUES



HIGHER ROI



FOCUS ON WELLNESS



GALLERY





JRE DEVELOPERS

JRE, a company incorporated by the promoters of DAA Home Private Limited, brings a legacy of trust, innovation, and expertise to real estate development.

With a deep understanding of the sector, JRL is driven by a clear vision — to create planned, secure, and value-rich communities that offer both lifestyle appeal and investment potential.

At JRL, we believe that real estate is more than just building structures — it's about shaping environments where people thrive and investments grow. Our developments are thoughtfully planned, legally sound, and strategically located to ensure lasting value for homeowners and investors alike.

We are committed to delivering excellence through every stage of our projects — from land acquisition and design to development and delivery. Transparency and timely possession are at the core of our operations, ensuring a seamless and trustworthy experience for every buyer. We build not just homes, but enduring relationships based on trust, quality, and long-term growth.

DAA Homes has successfully delivered landmark projects in Indri (Karnal) and Kurukshetra — a testimony to our unwavering commitment to quality and timely delivery.

FEATURED PROJECTS BY DAA HOME

DAA HOMES RESIDENCY, KURUKSHETRA

Spread across 12 acres, this thoughtfully designed residential enclave offers a perfect blend of affordability and elegance. DAA Homes Residency redefines community living, offering peace, connectivity, and modern infrastructure — all backed by on-time delivery and transparent processes.



PALM DRIVE, INDRI – KARNAL

A 25-acre planned township offering plots from 100 to 250 sq. yards, Palm Drive promises a modern, harmonious lifestyle. With timely possession, lush landscapes, and future-ready infrastructure, this project marks a new chapter in Indri's residential growth.



Whether you're looking for your dream home or a high-potential investment, JRL and DAA Homes offer unmatched opportunities across North India's most promising real estate destinations. Join us in building tomorrow's landmark communities — secure, sustainable, timely, and trustworthy.